

DOT HHS
 ECA
 NRI

DETAIL TABLE -- SPENDING COMPONENTS
 (10 year totals, amount in billions)

**Conf
 Proposal**

ENERGY

21st Century Energy Grid

Clean Energy Finance Authority

Clean Energy Lending Authority

Clean Energy Development Authority

Weatherization

State Energy Efficiency and Clean Energy Grants

Greening Federal Buildings

State and Local Procurement of CNG Buses and Light Trucks

Diesel Retrofits to Increase Efficiency of Older Trucks

Green Job Training

Federal Procurement of plug-in and other fuel efficient vehicles

Grants to State and Local Governments for projects to develop charging Infrastructure

Plug-In Hybrid Electric Vehicles (PHEV)

DOD near term energy efficiency technology demonstrations and research

DOD Energy Conservation Investment Program

Smart Appliances

45.28

11.01

15.00 ~~13.9~~

7.50

-1.1

7.50

5.00

6.30

4.50

0.30

0.70 ~~300~~

0.50

0.30

0.40

0.55

0.30

0.12

0.30

DETAIL TABLE – SPENDING COMPONENTS
 (10 year totals, amount in billions)

	Conf Proposal
INFRASTRUCTURE	118.88
Transportation	51.64
DOT/Highway Infrastructure (including funds for Secretary)	29.00
DOT/Transit Capital	8.40
DOT/Amtrak Capital (Including High-speed Rail)	0.85
✓ DOT/High Speed Rail/Passenger Rail Grants to States	48.85 8.0 1-2
DOT/Amtrak Rail Security	0.45
DHS/FEMA State and Local Grants for Transit Rail Security	0.30
DOT/Airport Grants	1.10
DOT/FAA Construction F&E	0.20
DHS/DOJ/TSA Explosive Detection (Aviation Security)	1.00
DHS/USCG Bridges	0.24
Assistance to Small Shipyards	0.10
Environmental	21.44
EPA - State Revolving Funds	6.00
EPA - Brownfields	0.10
EPA - Superfund	0.60
HUD - Lead Paint Abatement	0.10

DETAIL TABLE -- SPENDING COMPONENTS
 (10 year totals, amount in billions)

**Conf
Proposal**

	EPA - LUST		0.20
	DOE; Environmental Management	6.10	6.10 5
→	USDA - Rural Water and Wastewater Loans and Grants		1.38
	NOAA: Habitat Restoration		0.23
	Wildfire		<u>0.50</u>
	Corps		4.60
	Bureau of Reclamation		1.00
① →	NRCS: Watersheds		0.34
	Federal facilities		4.77
→	DOI/Natl Park Service		0.75
	United States Geological Survey		0.14
	DOI/BIA		0.50 ✓
	DOI/BLM		0.32 ✓
	DOI/Fish and Wildlife		0.28 ✓
→	USDA South Building Renovations and research facilities maintenance		0.20
2) →	CBP and ICE		0.70 -
	DHS HQ Construction	200 - DHS 450 - FS	0.65 -
	GSA/Federal facilities/New Construction	<i>et al.</i>	0.60 -
	USDA - Forest Service Infrastructure		0.65 -

DETAIL TABLE – SPENDING COMPONENTS
 (10 year totals, amount in billions)

	Conf Proposal
DOD – Construction	
FSRM	
Military Construction	
VA and VA cemeteries	
VA Medical Non-recurring Maintenance	
VA Health Care Construction	
VA Cemeteries	
State Department Domestic Infrastructure	
Diplomatic and Consular Services: Domestic Construction	
State Department IT	
International Boundary and Water Commission Construction	
Increase and protect affordable housing	
HUD/Public Housing Capital	
Emergency Shelter Grants	
HUD/Assisted Housing energy efficiency projects	
HUD/Neighborhood Stabilization Program	
HUD/HOME Block Grants	
③ Rural Community Facilities	
④ Rural Housing Insurance Fund	

7.00 *cut*
 4.24
 2.76
~~2.88~~ 1.0
 1.38
 -2.8 2.30
 0.13
 0.60
 0.09
 0.29
 0.22
 14.99
 4.0 ~~5.00~~
 1.50
 2.25
 2.00
 2.25
 0.13
 0.20

DETAIL TABLE — SPENDING COMPONENTS
 (10 year totals, amount in billions)

	Conf Proposal
<i>Native American Housing Block Grants</i>	0.51
<i>Emergency Food and Shelter</i>	0.10
<i>CDBG</i>	1.00
<i>Increase In FHA and GSE loan limits</i>	0.05
<i>Expand broadband coverage/1st responder interoperable wireless broadband</i>	7.20
Science	7.18
<i>NOAA: facilities and equipment</i>	0.60
<i>NIST: Lab Equipment — Boulder</i>	0.22
<i>NIST: Research facilities</i>	0.36
<i>DOE: Basic energy sciences</i>	1.60
<i>ARPA-E</i>	0.40
<i>NSF: University research instrumentation program</i>	0.10
<i>NSF: National labs</i>	0.40
<i>NSF: Highly-rated peer reviewed proposals</i>	2.50
<i>NASA: Equipment and instruments</i>	1.00
<i>Farm Service Agency IT-Modernization</i>	0.05
<i>Firefighter Assistance Grants</i>	0.21
EDUCATION AND TRAINING	102.31

— 2.825 - AG
 — 4,375 CJ

④

④
 ↓

DETAIL TABLE -- SPENDING COMPONENTS
 (10 year totals, amount in billions)

	Conf	Proposal
Early Childhood	4.60	
Increase QCDBG	2.00	
Head Start	1.00	
Expand Early Head Start	1.10	
Increase IDEA Infants and Toddlers	0.50	
Teachers for At-Risk and Special Needs Students	26.37	
Title I	10.00	3
School Improvement Grants	3.00	
IDEA Part B	4.90	
Teacher Incentive Fund	0.20	
HEA Title II (TOE)	0.10	
Homeless Education	0.07	
School Modernization	6.65	
Public school infrastructure investment (pre-k/charters; not higher ed)	6.00	
Modernization (repairing and refurbishing schools)	0.65	
Technology	3.00	
Higher education construction	0.10	
Impact Aid	0.25	
Data Systems		

11.7
~~10.00~~
~~4.90~~

10.00 - 145

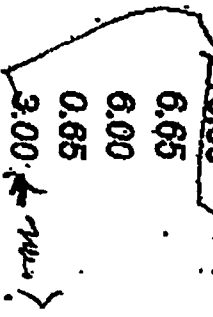

DETAIL TABLE - SPENDING COMPONENTS
 (10 year totals, amount in billions)

	Conf Proposal
Pell Grants	15.64
Mandatory Pell	1.47
Student Aid Administration	0.06
Job Training and Increasing opportunities for service	5.17
National emergency Grants	0.20
Community Based Job Training Grants - Community Colleges	0.25
Job Corps	0.25
Adult formula grants	0.50
Vocational Rehabilitation	0.54
Dislocated Workers	1.25
Youth formula grants	1.20
Employment Service state grants	0.40
YouthBuild	0.05
Increasing Opportunities for Service:	0.45
Expand National Service	0.20
Additional College Work Study Funds as an Incentive for service	0.20
Non-Profit Recovery Fund	0.05
Enforcement of Worker Protection Laws	0.08
Education block grant	44 00.00

Handwritten: 13 90 P11015

DETAIL TABLE - SPENDING COMPONENTS
 (10 year totals, amount in billions)

	Conf Proposal
<i>Innovation and Incentive funds</i>	5.00
<i>Other</i>	34.00
HEALTH	152.44
COBRA	27.50
Temporary Medicaid and SCHIP FMAP Increase	90.00
Expand adoption of Health IT - Appropriations	3.00 ←
Expand adoption of Health IT - Ways and Means	16.38
Comparative Effectiveness Research	1.10
Prevention - Wellness Trust (Including 317 Immunizations)	1.00
Community Health Centers	2.00 ←
Strengthening the health care workforce	11.46
<i>Health Workforce Investments</i>	0.50
<i>Indian Health Service</i>	0.50
NIH	10.00 ←
 Lab Construction	0.44
HHS IT Security	0.05
PROTECTING THE MOST VULNERABLE	72.257
Unemployment Insurance	38.74

**Conf
Proposal**

18 →	Supplemental Nutrition Assistance Program (Formerly Food Stamps)	19.99
	<i>Temporary 10% increase in SNAP Benefit (phases out over 24 months; suspending price indexing of benefits)</i>	19.69
	<i>Temporary increase in SNAP admin funding</i>	0.30
	Other Nutrition	0.75
10 →	Increase WIC funding	0.50
11 →	Expand CACFP Afterschool Meals	0.10
12 →	Food banks (TEFAP)	0.15
	SSI, Replenish TANF Contingency Fund, and Child Support Enforcement	6.53
	Program Performance and Integrity	1.00
	Build SSA's New National Computing Center	0.50
	Reduce disability insurance backlog	0.50
	Veterans benefits processing	0.20
	Information Technology	0.05
	Temporary surge VA claims processors	0.15
	Increasing the EITC	3.64
	CSBG	1.00
	Aging Services Programs	0.10
	Centers for Independent Living	0.14

DETAIL TABLE - SPENDING COMPONENTS
 (10 year totals, amount in billions)

	Conf Proposal
Community Development Financial Institutions	0.10
IRS tax implementation	0.08
OTHER	21.37
Decennial Census and Economic Statistics	1.00
DTV - expanded coupon program	0.65
State and local law enforcement	4.00
⑩ ⑬ USDA - Rural Business Service Loan and Grants	0.15
SBA	0.72
EDA	0.15
Inspectors General	0.21
GAO	0.03
Recovery Act Transparency Board	0.014
Financial reporting improvements	0.06
Recovery oversight program management (GSA and OMB)	0.01
<u>Economic recovery payments</u>	14.38
SUBTOTAL:	512.53
	Appropriations only: 315.366